

Courses and distances
down Clarion River

S. 55 W 33
N. 80 W 80
S. 88 W 18
S. 67 W 16
S. 55 W 92

Total = 239

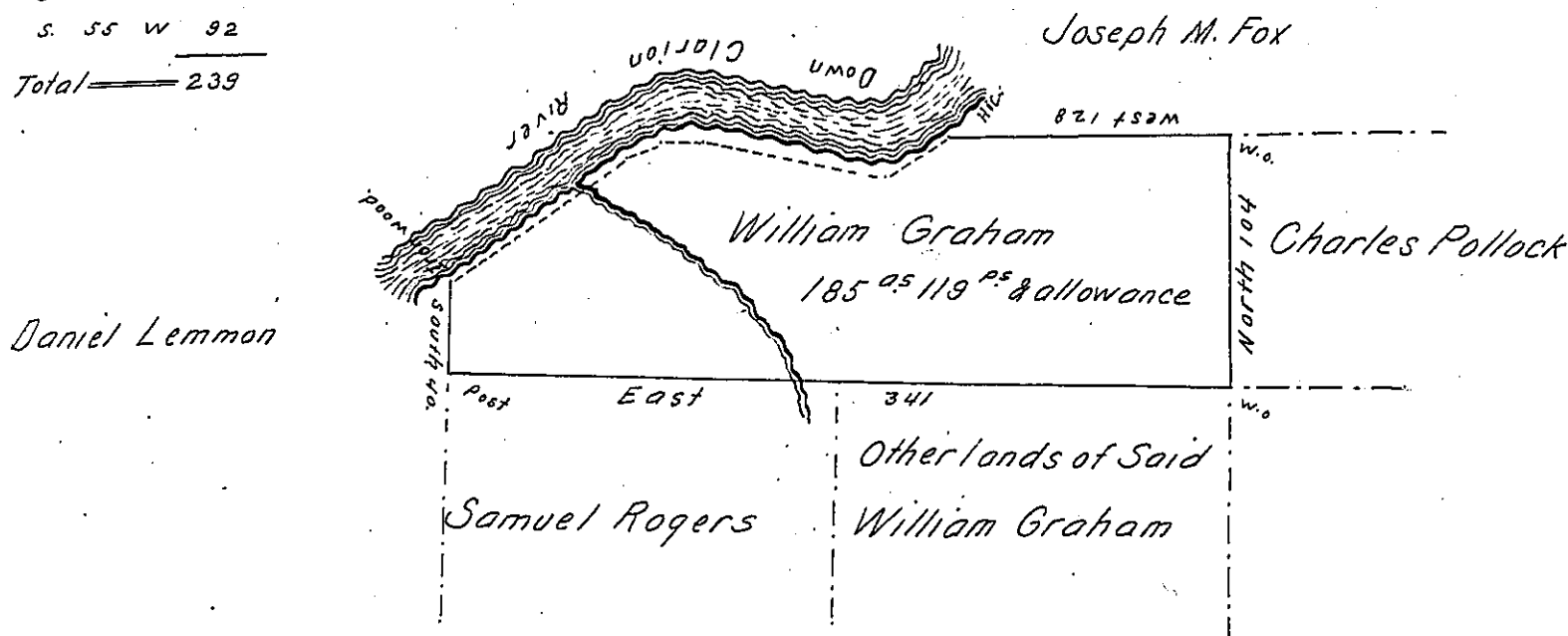

In pursuance of a Warrant dated July 5th 1839. Granted to William Graham. Surveyed to the Same on the 16th day of July 1839. The above described tract of land containing one hundred and Eighty three acres. one hundred nineteen perches and allowance of Six per cent &c. Situate in Perry Township Armstrong County

To Jacob Sallade Esqr. } For Isaiah Guthrie D. S.
Surveyor General } J. E. Meredith.

I do certify that I have examined the above return of Survey and find it to be correct.

Isaiah Guthrie D.S.

IN TESTIMONY that the above is a copy of the original remaining on file in the Department of Internal Affairs of Pennsylvania, made conformably to an Act of Assembly approved the 16th day of February, 1833, I have hereunto set my Hand and caused the Seal of said Department to be affixed at Harrisburg, this seventeenth day of January 1905.

George B. Johnson
Secretary of Internal Affairs.